

NM I59 Vehicle Length Study

Public Information
Meeting

October 5, 2023

Bohannon  Huston



New Mexico DEPARTMENT OF
TRANSPORTATION
MOBILITY FOR EVERYONE

Introductions

New Mexico Department of Transportation NMDOT

Brad Julian
Aaron Chavarria
Harold Love
Andreas Linnan
Andrew Guerra

Consultants: Bohannon Huston Inc.

Bert Thomas, Project Manager
Joseph Kaberlein, Design Engineer
Liz Treat, PI Coordinator

Bohannon  Huston



New Mexico DEPARTMENT OF
TRANSPORTATION
MOBILITY FOR EVERYONE

Agenda

- Project Overview
- Existing Conditions & Concerns
- Vehicle Tracking Analysis
- Conclusions & Recommendations
- Questions & Comments



Project Overview



Study Location



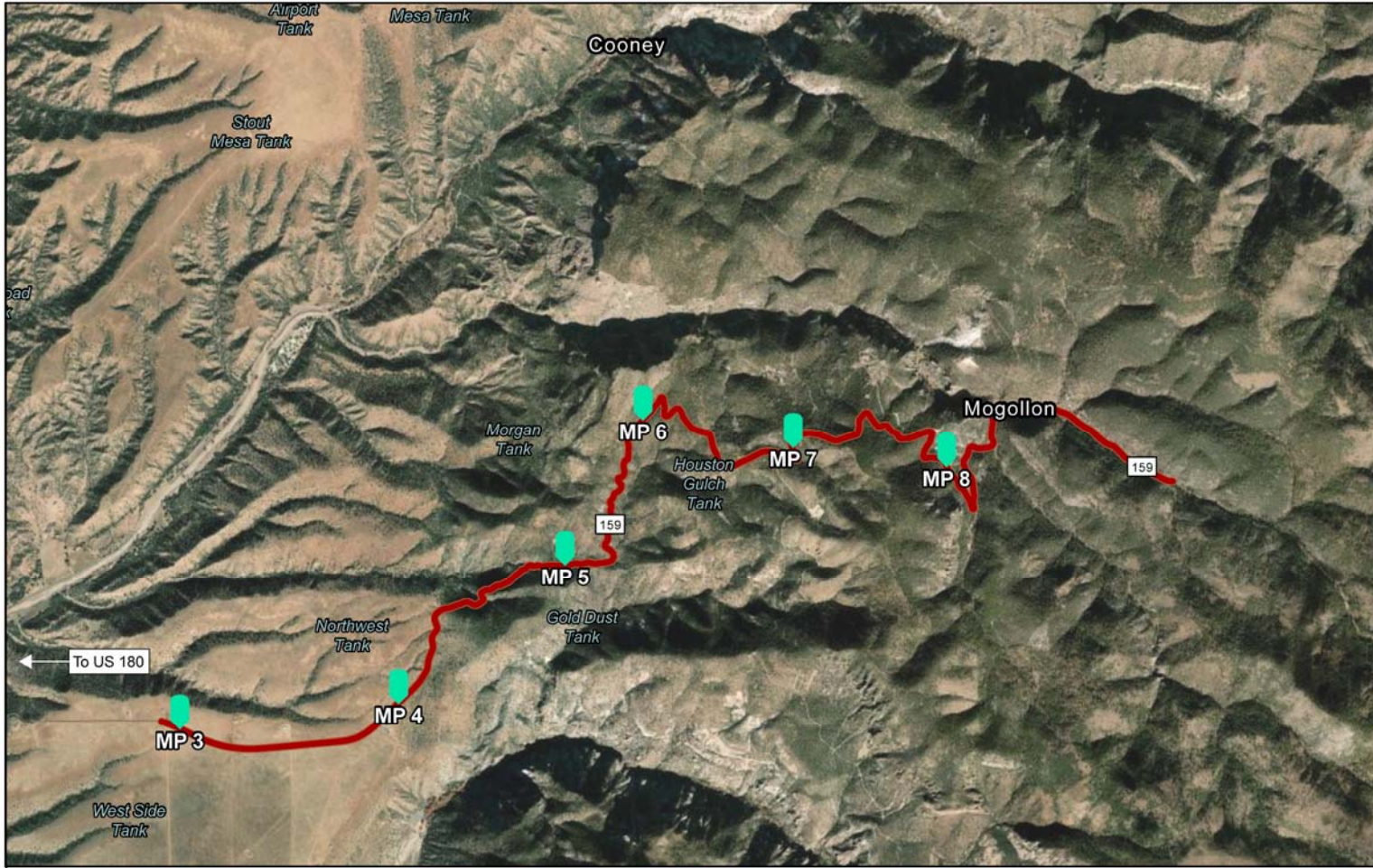

Study Purpose



Study Purpose

- Public concern of large vehicles and potential road closures.
- NMDOT study of vehicle type and length.
- Provide recommendations to maintain & improve safety.

Existing Conditions



Roadway Characteristics

- Steep grades
- Limited sight distance
- Horizontal curves
- Narrow roadways
- Roadside features



Traffic Characteristics

Traffic Volumes

- Low traffic volumes
- Various users and vehicle types

Crash History

- 4 crashes reported on NM 159 between 2017 and 2021

Current Vehicle Restrictions



Vehicle Restrictions

Current Length Restriction

- 46 feet
- 30-46 ft: Pilot car

Public Concerns



Public Concerns

- Width of roadway
- Conflicts with oversize vehicles
- Numerous curves
- Roadway conditions and maintenance



Vehicle Tracking Analysis



Vehicle Tracking Analysis

Selection of design vehicle:

Motorhome

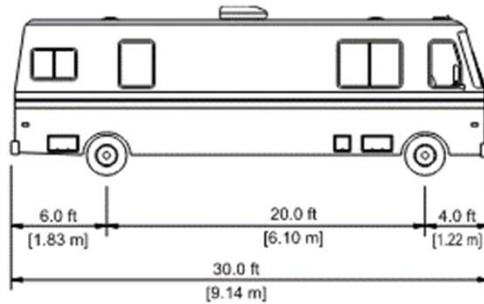

SU-30 (Single-unit truck)

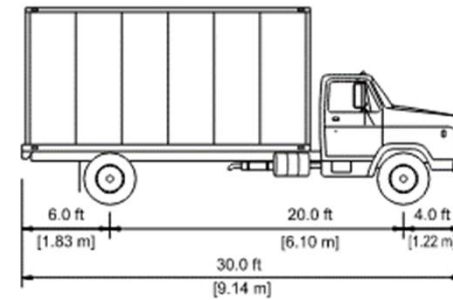

WB-40 (Intermediate semitrailer)

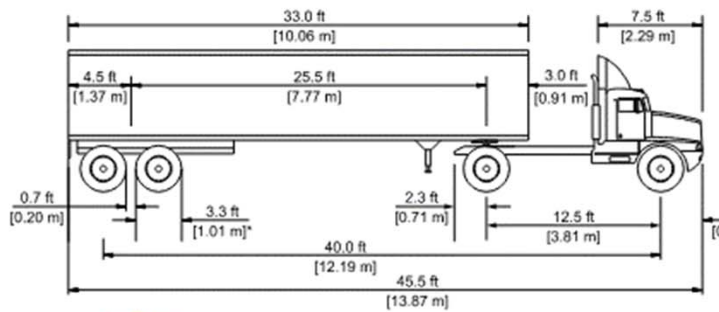

WB-67 (Interstate semitrailer)

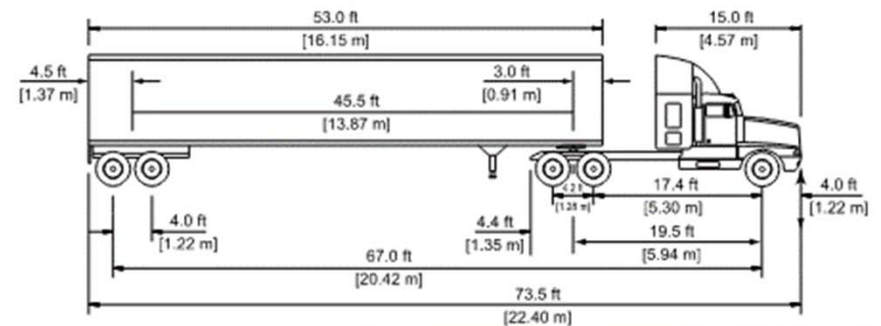

Vehicle Tracking Analysis

WB-40 at MP 6

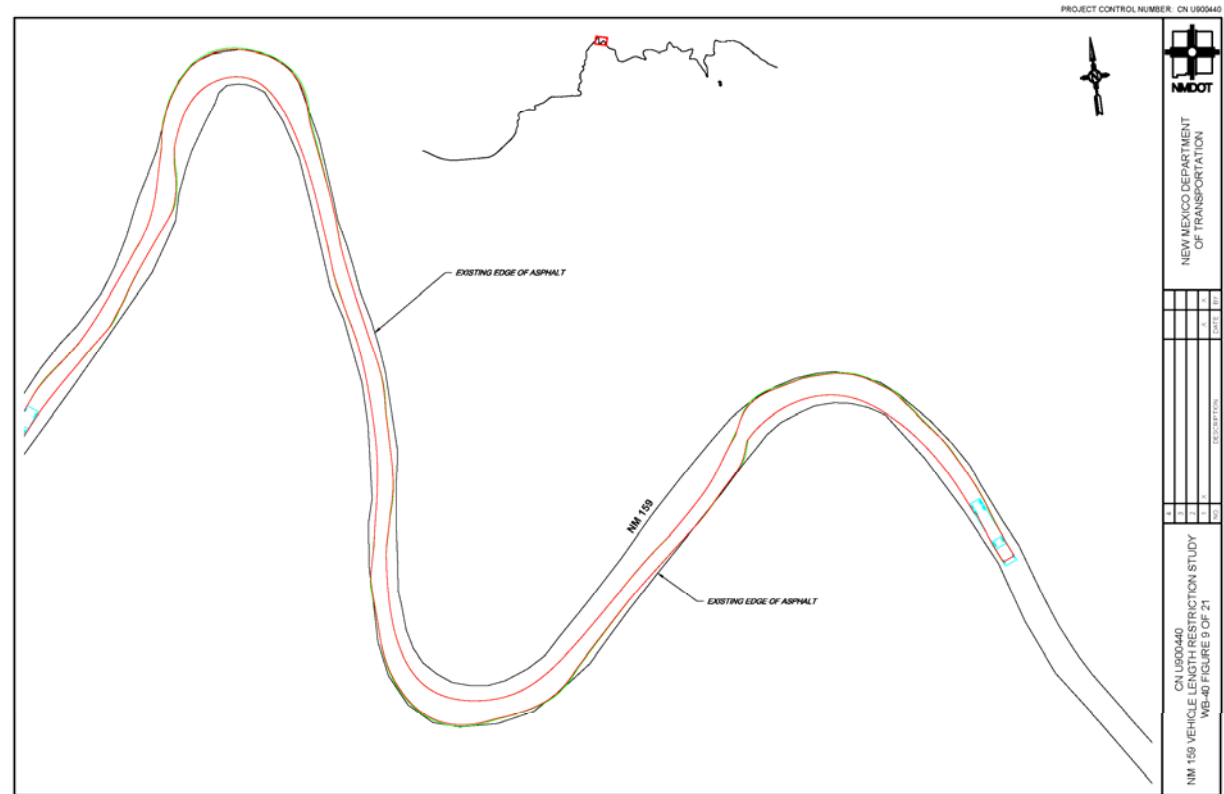
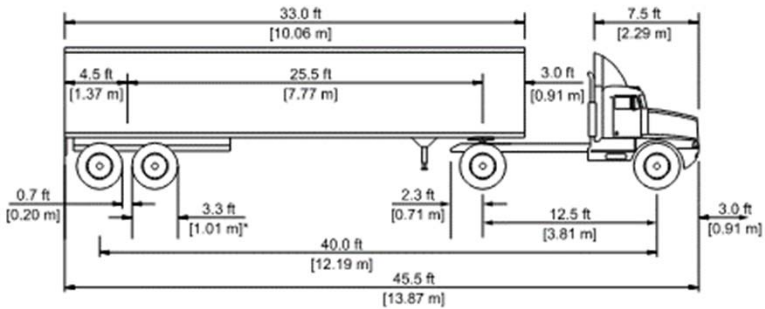

PROJECT CONTROL NUMBER: CN U900440



NEW MEXICO DEPARTMENT OF TRANSPORTATION

NO.	REVISION	DATE
1		
2		
3		
4		
5		
6		
7		
8		
9		
10		

CN U900440
NM 159 VEHICLE LENGTH RESTRICTION STUDY
WB-40 FIGURE 9 OF 21

21:23:31 LABELLEN Drawing File: P:\023052\TRANSPORT\1010101\RAUDY\FIG9\FIG9023052_09801.Plot.DWG 10:52 AM

PROJECT DEVELOPED BY: DRAWING SCALE: 1" = 50' SHEET NO. FIG. 9



Vehicle Tracking Analysis

SU-30 at MP 6

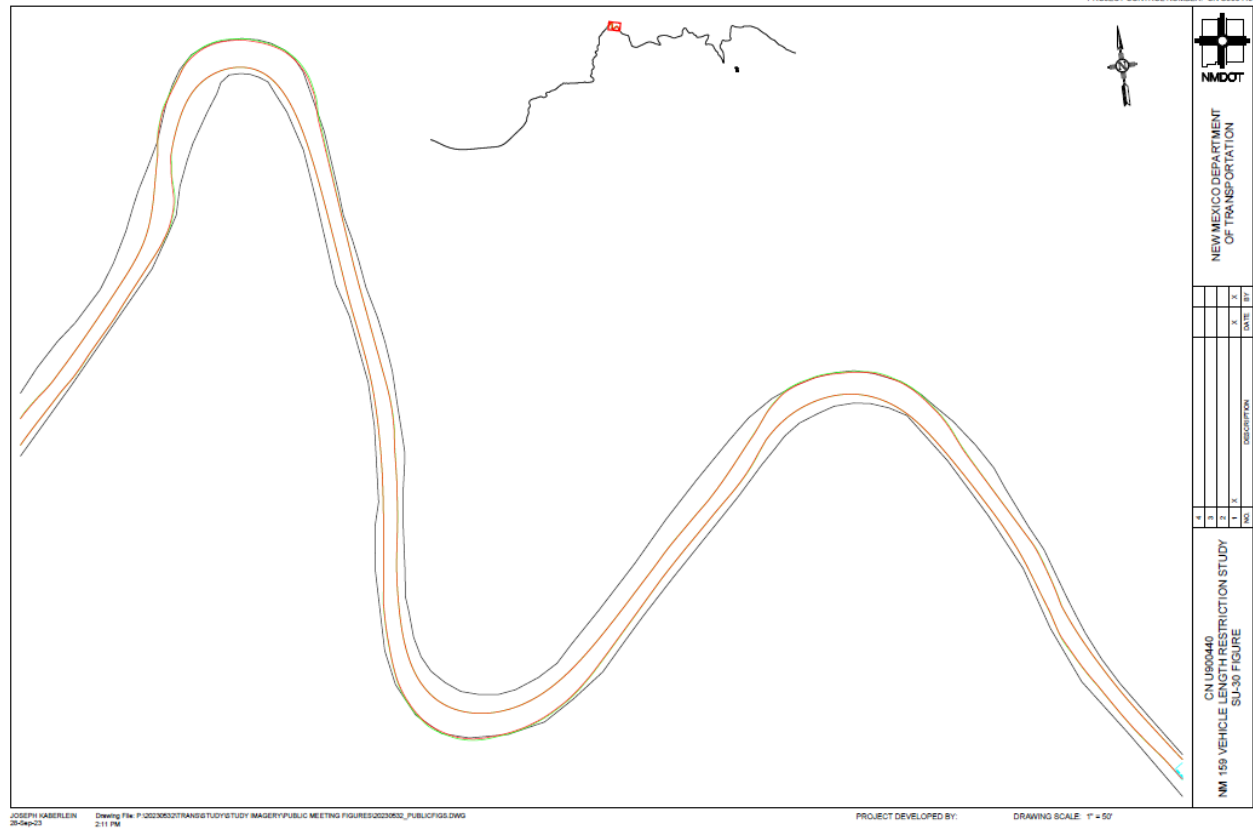
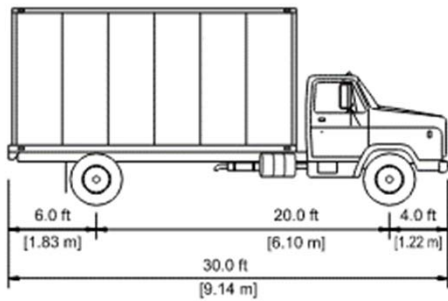

Vehicle Tracking Analysis

Motorhome at MP 6

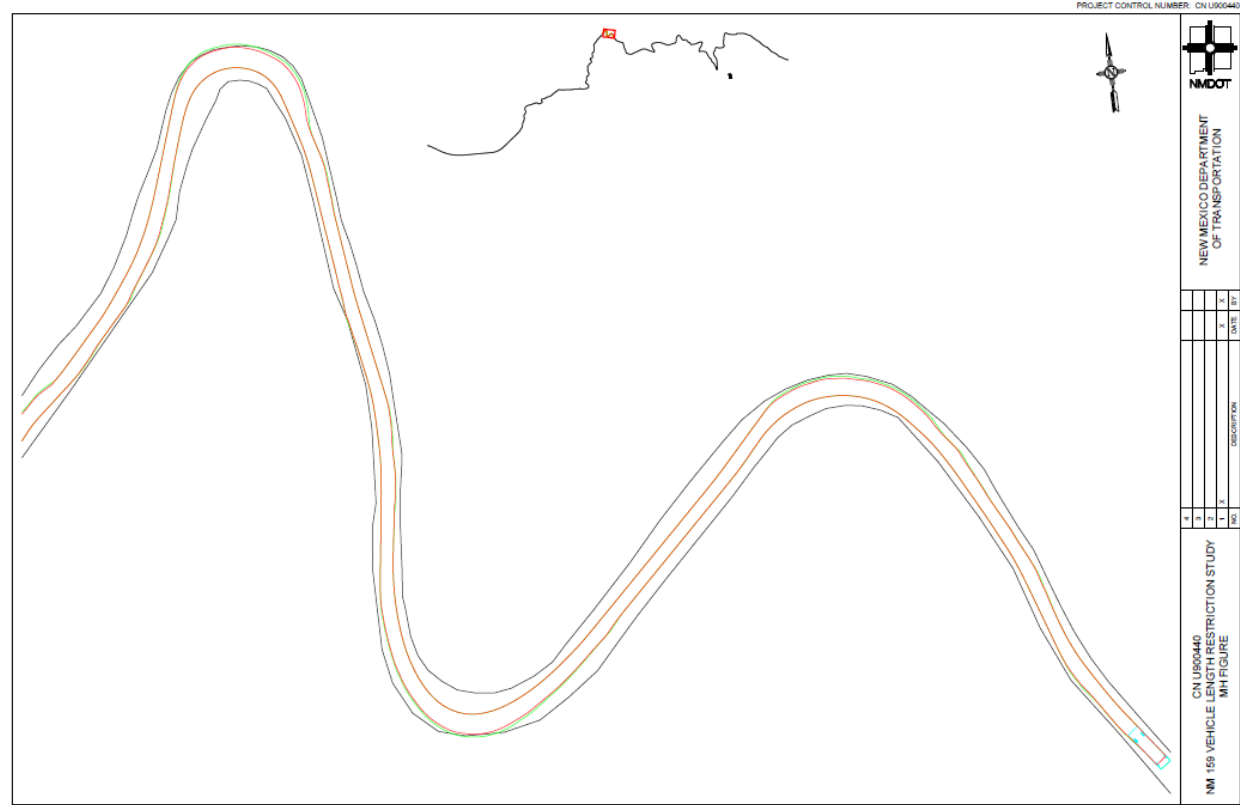
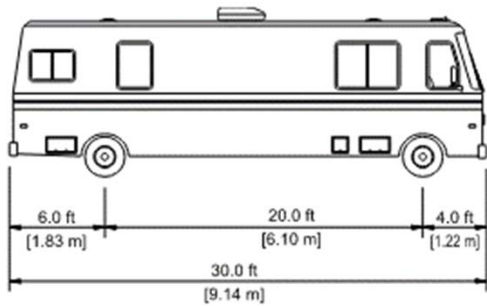

Results

	AASHTO Design Vehicle			
	Motorhome	SU-30	WB-40	WB-67
Number of Curves Failing to Accommodate	1	1	5	40

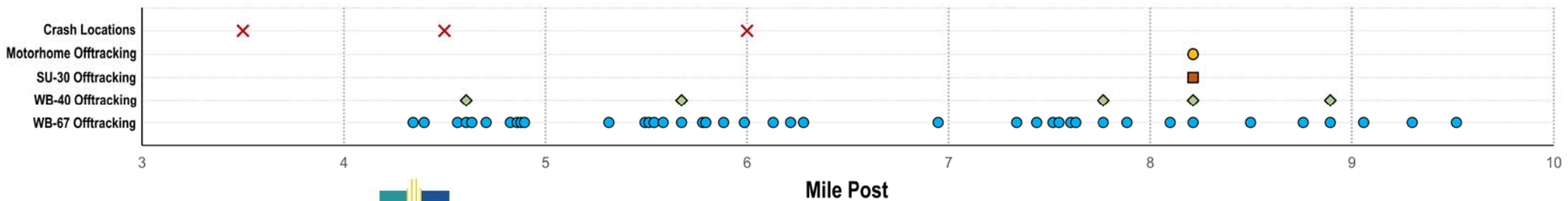

Conclusions & Recommendations



Conclusions

- Roadside environment is not very forgiving
- Poor horizontal sight distance at curves
- NM 159 functions as one way in and one way out
- MP 8.2 tight curve



Recommendations

Study supports interim restrictions:

- Pilot vehicle with lengths over 30 feet
- Larger vehicles prohibited

Recommend Improved Signing

Recommendations

Improve
Signage:



Questions & Comments

Questions?

Link to the Draft Report:
<https://bhinc.com/NM-159/>

Email: Outreach@bhinc.com

Phone: 505-264-0111

Mail: Liz Treat, 7500 Jefferson St NE, Albuquerque, NM 87109

Please submit comments by **October 19th**.



Bohannon  Huston



New Mexico DEPARTMENT OF
TRANSPORTATION
MOBILITY FOR EVERYONE